

068R9545

068R9545

## EV 227B (EVSR)

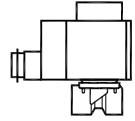

### EV 227B 10

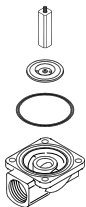
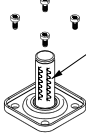
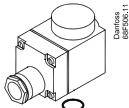
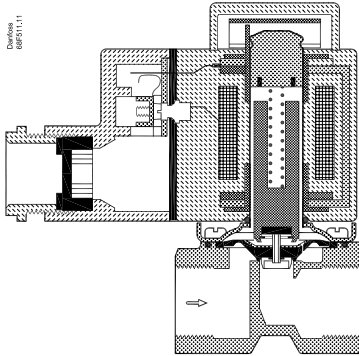

EV227B 10 B G38 /  
E NC 000 /  
032UXXXX / WWY /  
made in XXXXXXX

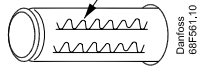

Danfoss  
68F501,10

### EV 227B 12-22

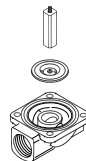
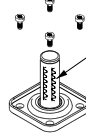
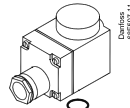
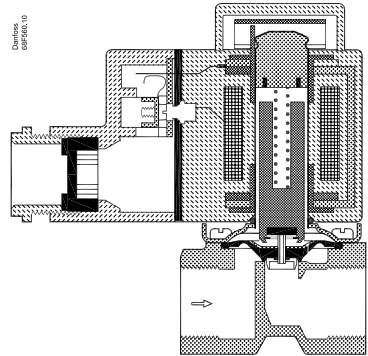

EV227B 22 G1 /  
E NC 000 /  
032UXXXX / WWY /  
made in XXXXXXX

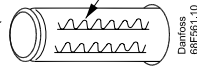

Danfoss  
68F502,11

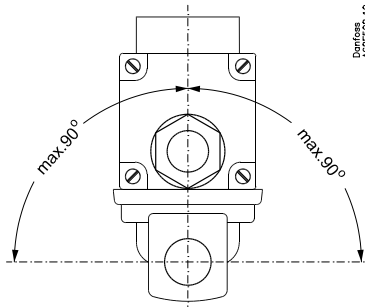

Danfoss  
A6F505,10

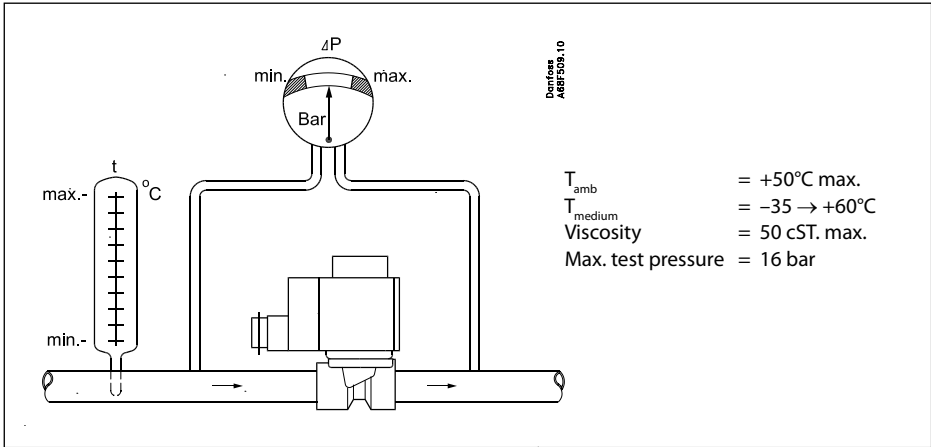

Danfoss  
ABF443.10

EV 227B	Nm	kpm	ft-lbs
10	1.4	0.14	1.0
12	2.8	0.28	2.0
14	2.8	0.28	2.0
18	4.5	0.45	3.2
22	4.5	0.45	3.2

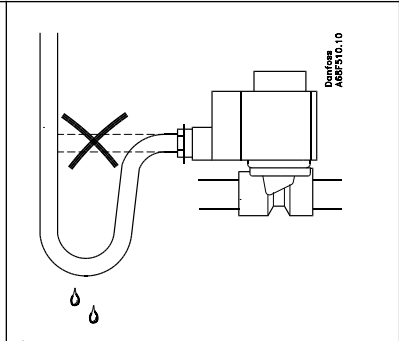

NC  $\Delta p$ bar						
	10 W a.c.		12 W a.c.		20 W d.c.	
	min.	max.	min.	max.	min.	max.
EV 227B	0.1	5.0	0.1	5.0	0.1	5.0

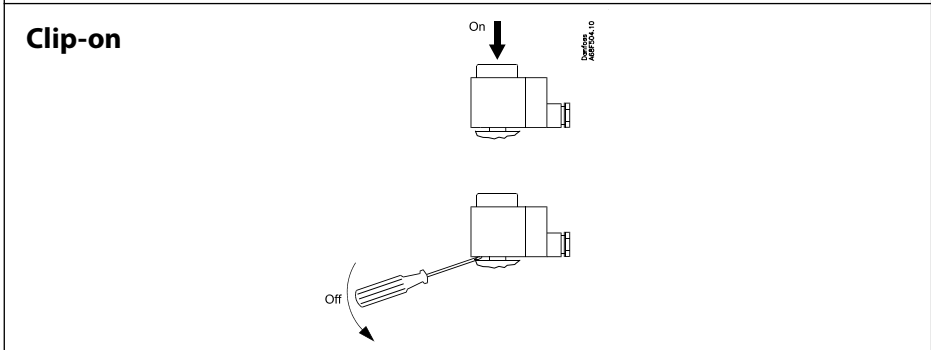

Danfoss can accept no responsibility for possible errors in catalogues, brochures and other printed material. Danfoss reserves the right to alter its products without notice. This also applies to products already on order provided that such alterations can be made without substantial changes being necessary in specifications already agreed. All trademarks in this material are property of the respective companies. Danfoss and the Danfoss logotype are trademarks of Danfoss A/S. All rights reserved.