

Installation guide

Solenoid valve

Type EV228BW 15-50 + Coil type BB/BE DC

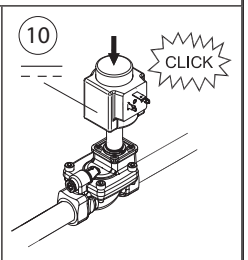
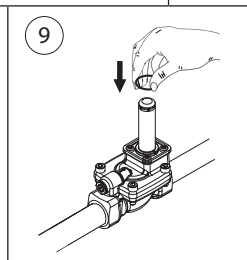
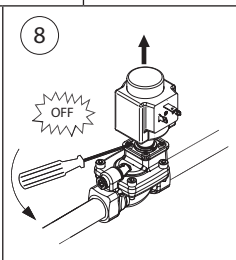
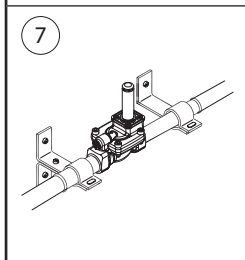
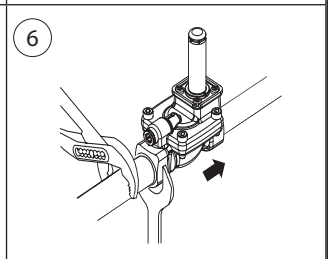
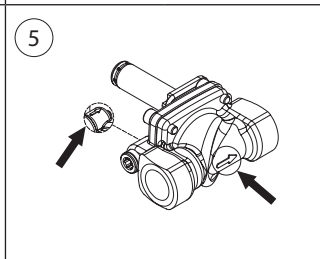
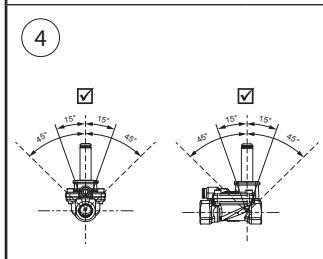
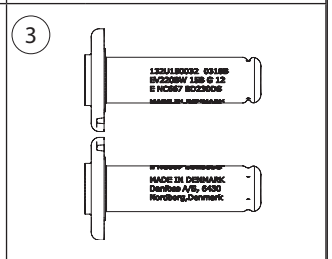
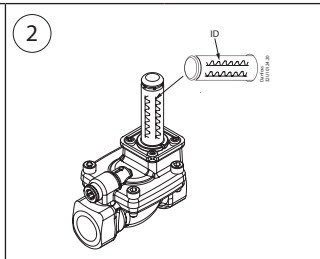
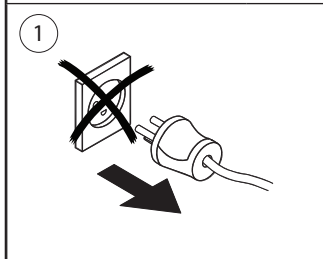
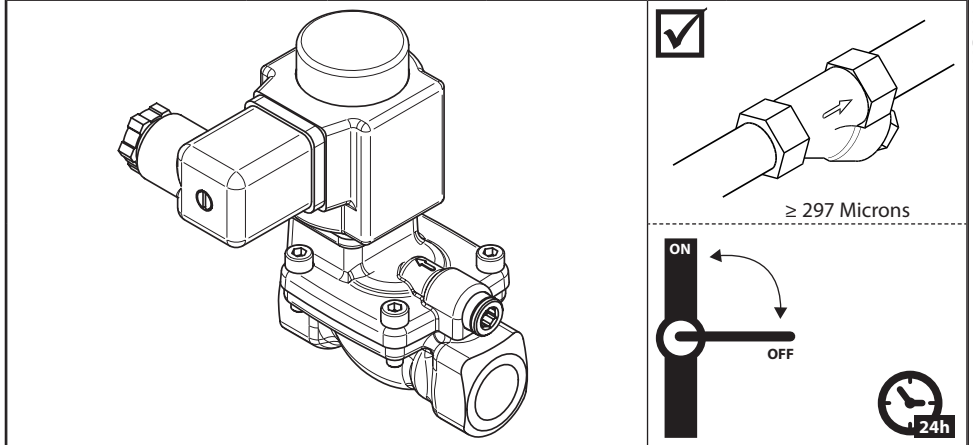

132R9001

132R9001

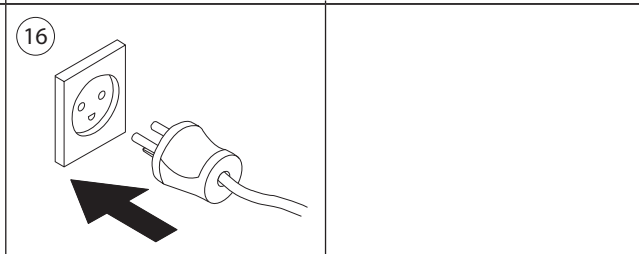
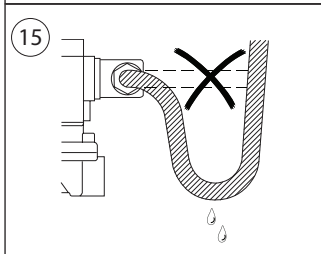
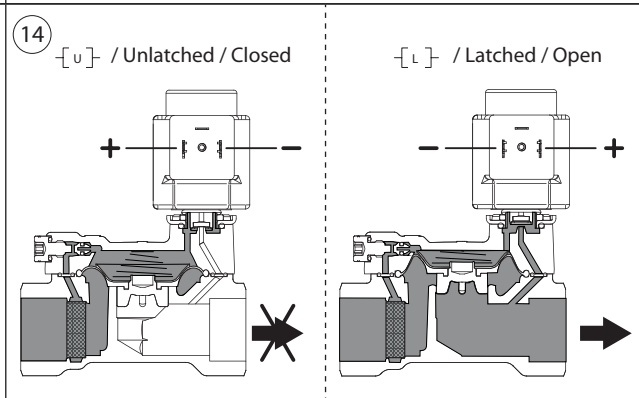
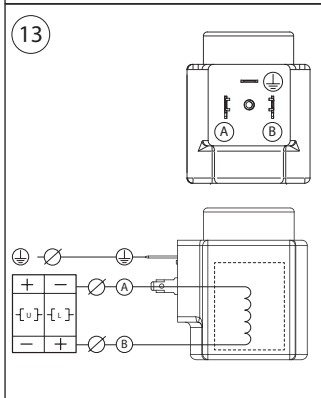
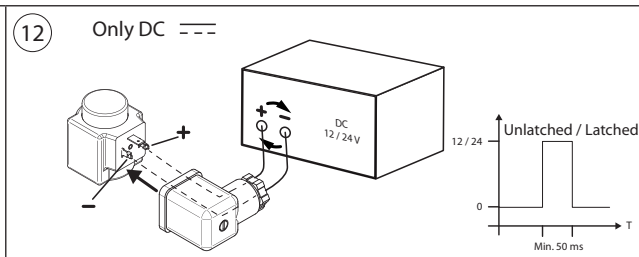
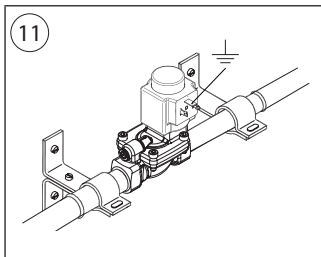



Drinking water approval

 CERTIFIERAD 1002	 RI SE	Valid in	Certificate no.
 356 Inspected by DTI		DK, SE	SCO155-18 *)
EV228BW 15-50			

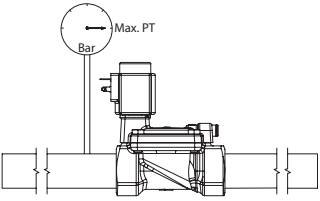

DN	Max. Working Pressure (MWP) [bar]	Max. Test pressure (PT) [bar]
15 - 50	10	25
EN 60730-2-8		