

Installation guide

Thermostatic expansion valve

Type TCBE / TCCE / TCAE

068R955Z

068R955Z

Standard refrigerants:
See product label

Max. working pressure:
PS / MWP: 45.5 bar / 660 psig

Max. test pressure
 $P_{test} = 45.5 \text{ bar} / 660 \text{ psig}$

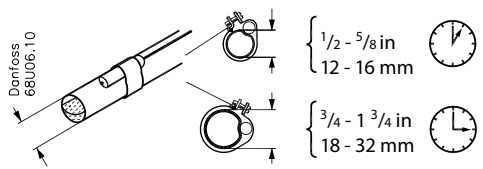
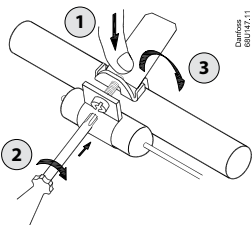
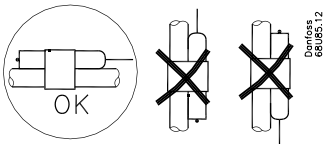
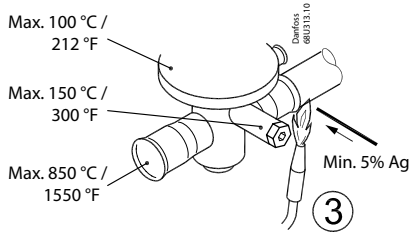
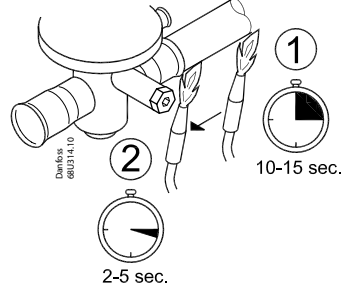
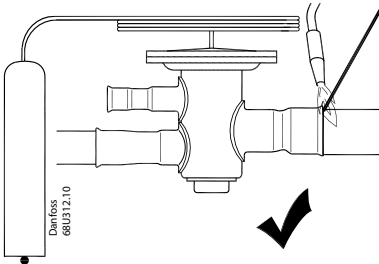
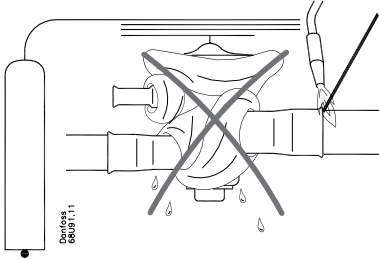

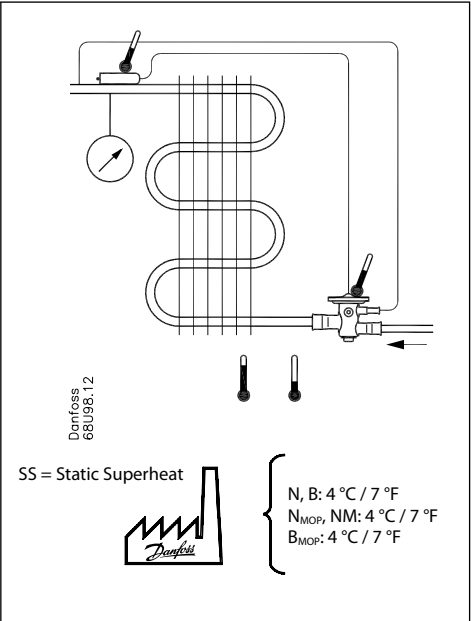
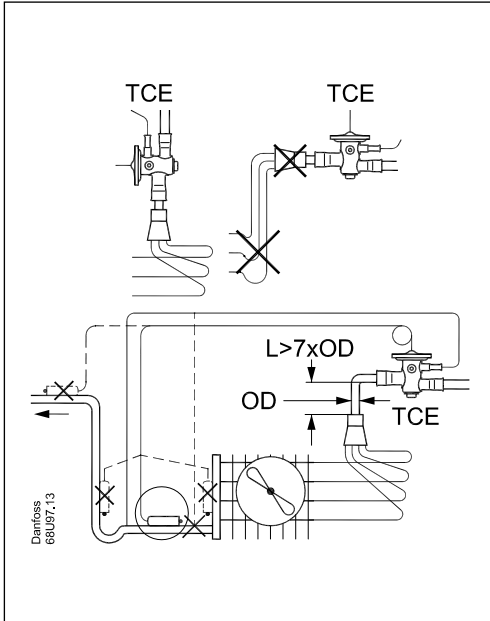

DANFOSS A6B061.10

4 mm 5/32 in

Stop

DANFOSS A6B062.10

DANFOSS A6B083.10

4Nm (3ft-lbs)

R22/R407C	R134a	R404A/R507	R410A	ΔSS
-	N	-	-	1 × 1 °C (1.8°F)
N	NM	N,B	N,B	1.5 °C (2.7°F)
NM,B	-	NM	NM	2 °C (3.6°F)

Temperature ranges:

N = -40 - 10 °C / -40 - 60 °F

NM = -40 - -5 °C / -40 - 25 °F

B = -60 - -25 °C / -75 - -15 °F