

## PUMP PERFORMANCE CURVES

TYPE Submersible General Dewatering Vortex Pump	MODEL HS3.75S -51 HSZ3.75S -51	FREQUENCY 50 Hz
---	--------------------------------------	--------------------

CUSTOMER'S NAME \_\_\_\_\_

EQUIPMENT TITLE \_\_\_\_\_

NO. \_\_\_\_\_

	STANDARD SPECIFICATIONS	REQUIRED SPECIFICATIONS
DISCHARGE BORE	80 mm	mm
TOTAL HEAD	MAX. 18 m	m
CAPACITY	MAX. 0.30 m <sup>3</sup> /min	m <sup>3</sup> /min
MOTOR OUTPUT	0.75 kW	kW
PHASE x VOLTAGE	1 $\phi$ x V	$\phi$ x V
CURRENT	A	A
POLES / REVOLUTION	2 P / s. s. 3000 min <sup>-1</sup>	P / min <sup>-1</sup>
STARTING METHOD	CAPACITOR MOTOR	
INSULATION CLASS	E	

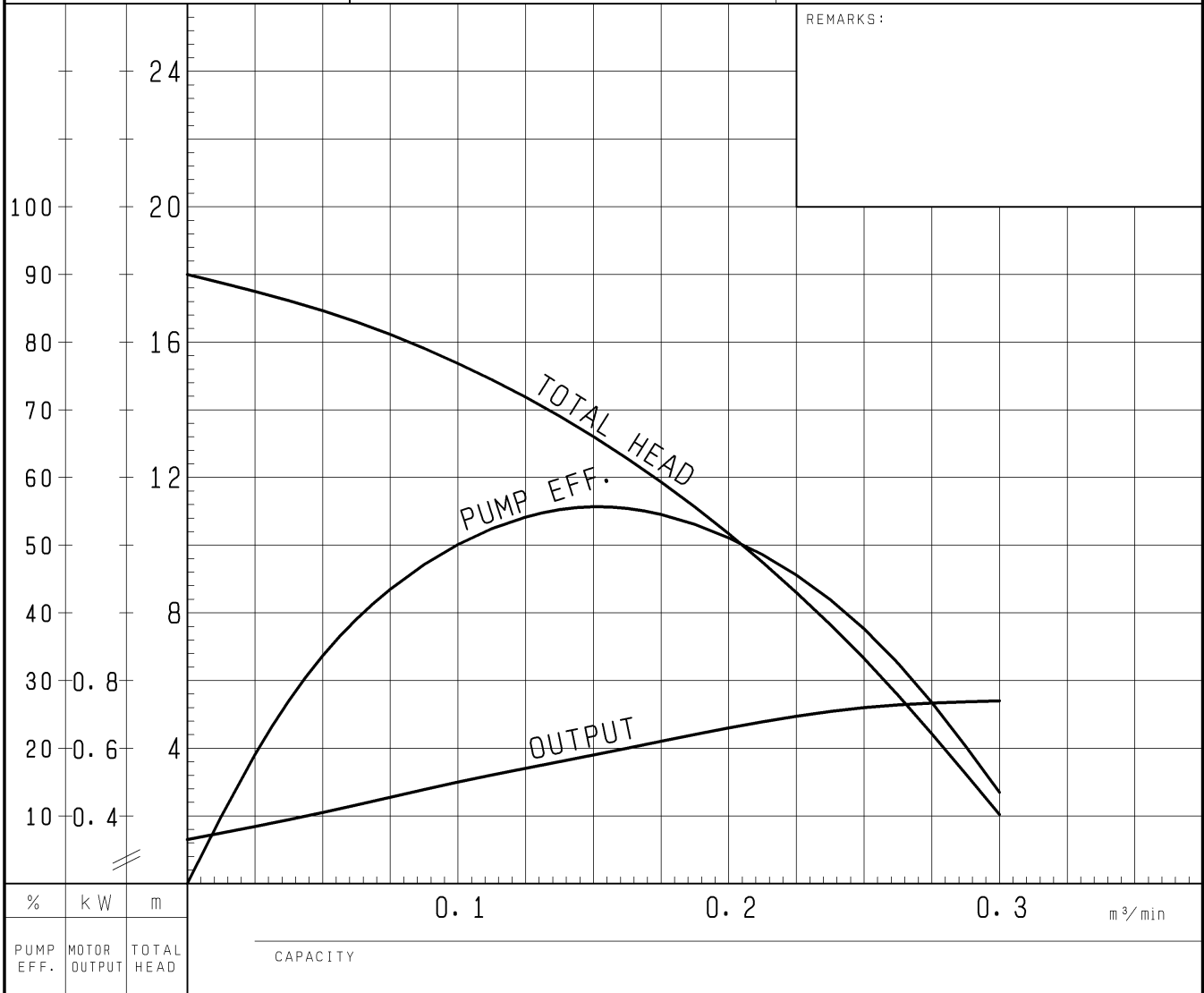

<b>DIMENSION DRAWING</b>		No.	No. A-15027-1
TYPE	Submersible General Dewatering Vortex Pump	MODEL	HS3.75S -51/61

Approximate Weight (※)
17.5kg

※excluding cable

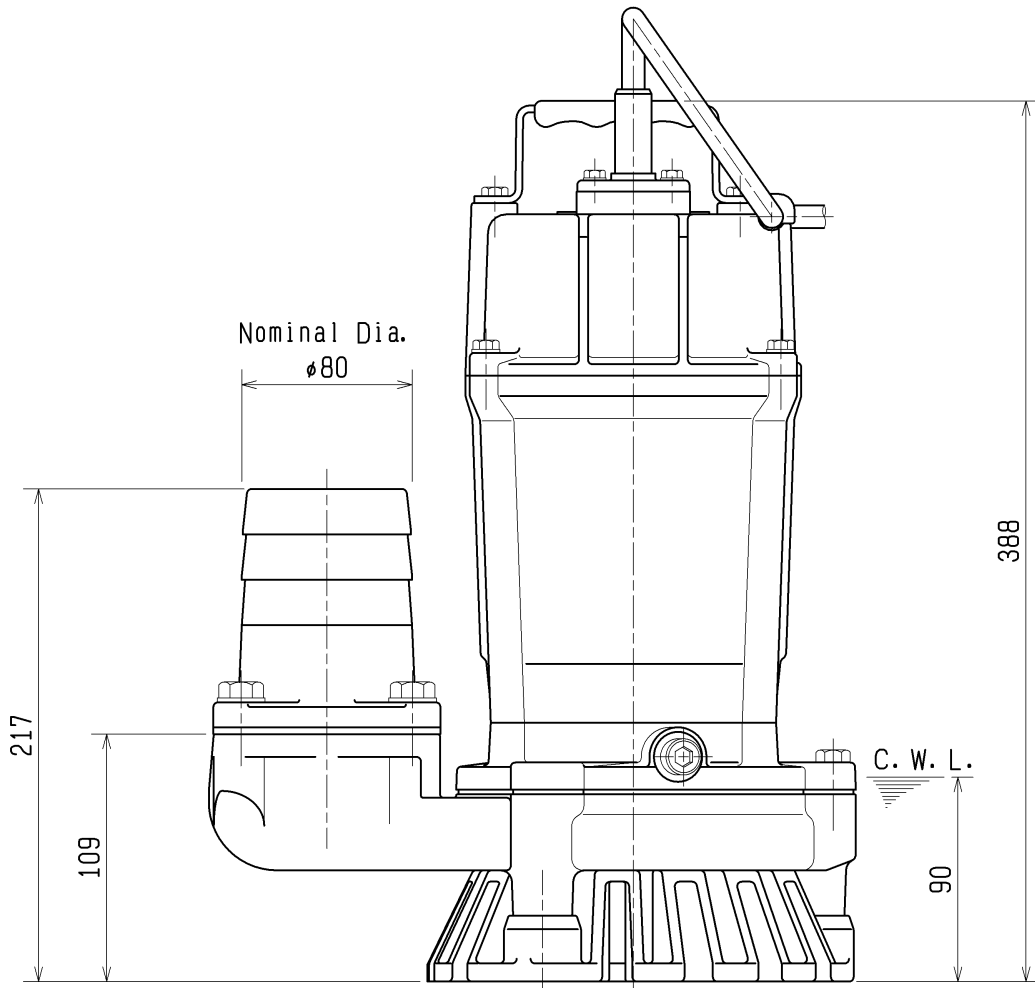
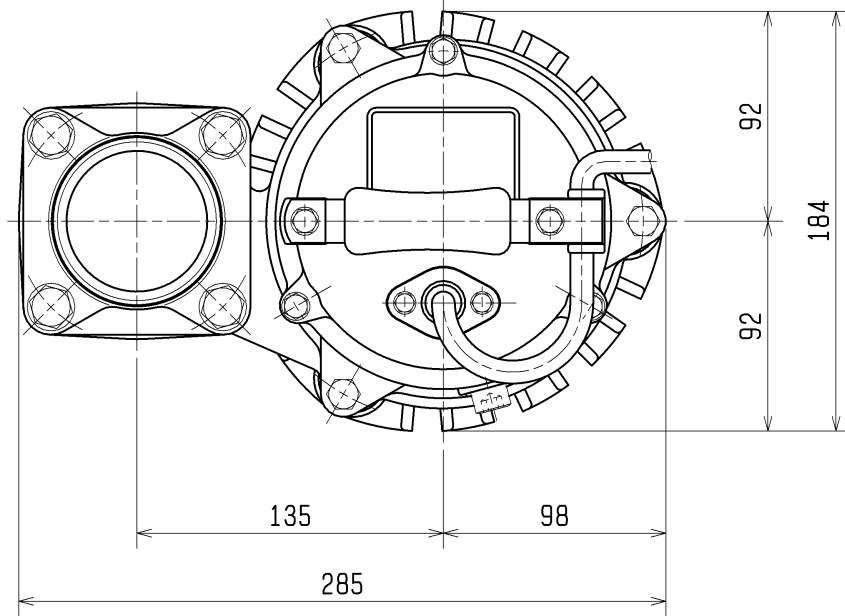

C. W. L. :Continuous running Water Level

<b>SECTIONAL DRAWING</b>		No.	No.
TYPE Submersible General Dewatering Vortex Pump		MODEL HS3.75S -51/61	
		No. A-15031-2	

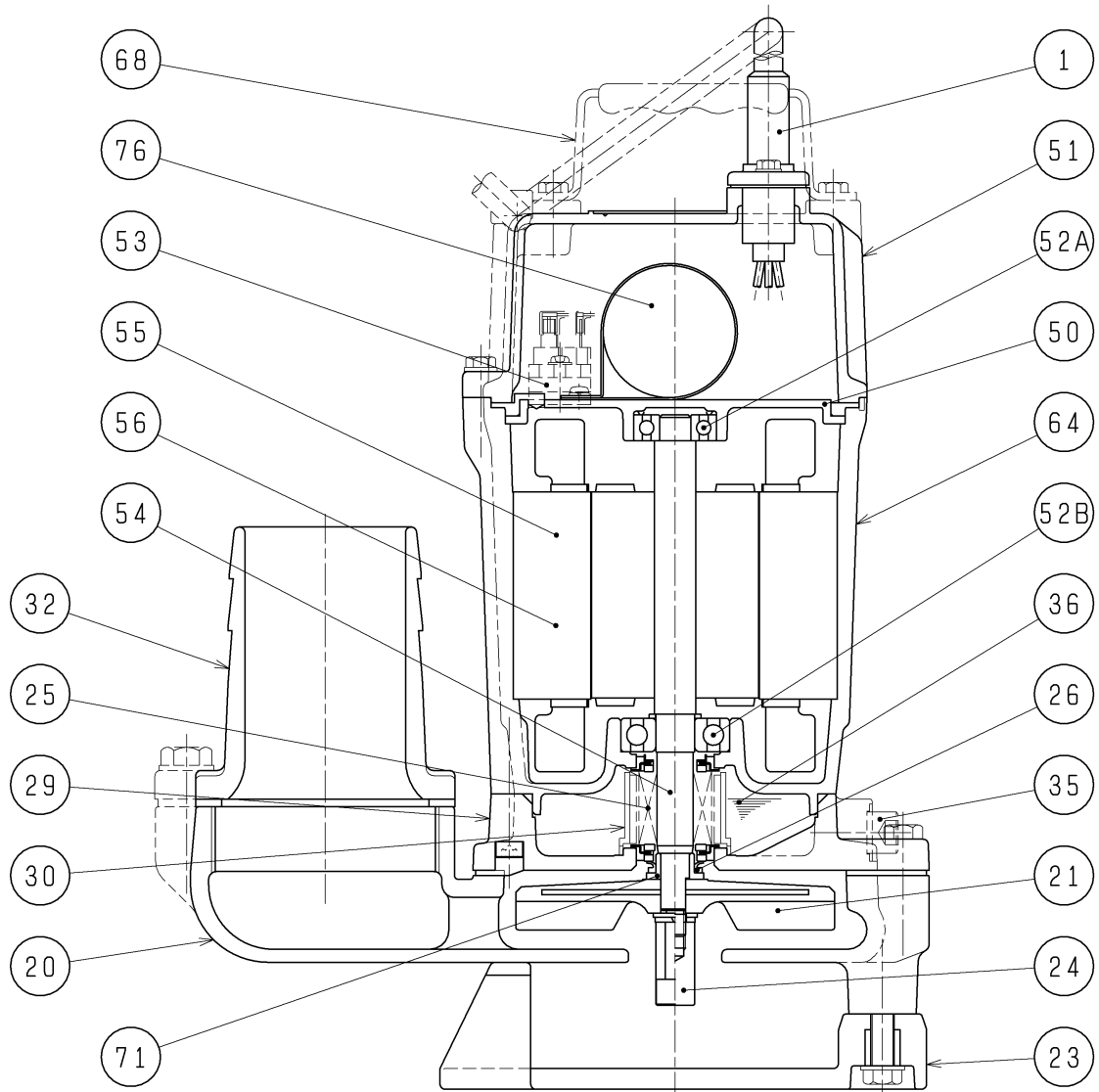

REQ. SPECIFICATION

※ the wetted part

No.	DESCRIPTION	QTY	MATERIAL / NOTE	No.	DESCRIPTION	QTY	MATERIAL / NOTE
1	Cable	1	PVC Sheath	51	Motor Head Cover	1	Aluminium Die Casting
20	Pump Casing	1	Ductile Iron Casting	52A	Upper Bearing	1	6201ZC3
21	Impeller	1	Urethane Rubber	52B	Lower Bearing	1	6302ZC3
23	Strainer Stand	1	Vinyl Chloride	53	Motor Protector	1	
24	Stirrer	1	Sintered Alloy	54	Shaft	1	Stainless Steel 403(※)
25	Mechanical Seal	1	W-14VC	55	Rotor	1	
26	V-ring	1	Nitrile Butadien Rubber	56	Stator	1	
29	Oil Casing	1	Ductile Iron Casting	64	Motor Frame	1	Aluminium Die Casting
30	Oil Lifter	1	Plastic	68	Handle	1	Steel Sheet & Natural Rubber
32	Hose Coupling	1	Aluminium Die Casting	71	Shaft Sleeve	1	Stainless Steel 304
35	Oil Plug	1	Stainless Steel 304	76	Capacitor	1	
36	Lubricant		Turbine Oil (ISO VG32)				
50	Motor Bracket	1	Aluminium Die Casting				